



فرست اوتوماشن

Light Fittings

Series CZ0870d



Prodcuts Features

- It is energy-saving and environmental protection which the power consumption is only 19% of the same brightness of incandescent lamp.
- It is long life and maintenance-free which the service life is up to 50000 hours and the maintenance-free of long term.
- There is a feature of good electromagnetic compatibility and it does not cause interference to the system power grid.
- It is not influenced by the voltage fluctuations and can be operated in the wide voltage range of AC100 ~ 240V.
- There is a good performance of vibration due to the LED is the solid-state light source.
- The highest class of flameproof is up to IIC.
- It is convenient to be mounted and maintained.
- The degree of protection is up to IP 66.
- International IECEx Approval, Europe union ATEX Approval.





فرست اوتوماشن

Light Fittings

Series CZ0870d



Product Parameter

Product type:	LED Explosion-proof light fittings
Certification:	CCC IECEX ATEX
Application range (zones):	2G/Gb/zone 1; 2D/Db/zone 21
Min.ambient temperature:	-40°C
Max.ambient temperature:	+55°C
Degree of protection:	IP66
Rated voltage:	100 ~ 240V AC 50/60Hz



فرست اوتوماشن

Light Fittings

Series CZ0870d

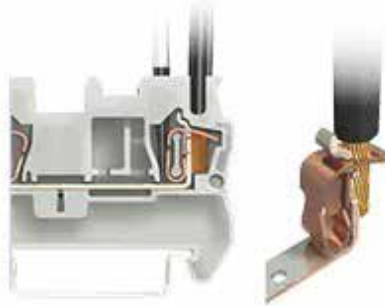

It is easier to be wired by cage type terminal which is certified internationally.



Explosion-proof platform light fittings
C-90°



Bracket type lamps



Explosion-proof bracket type lamps,
bracket installation, multiple angle adjustment



Explosion-proof platform light fittings
D-25°



Street lamp type



Installation of wall type lamp



فرست اوتوماشن

Light Fittings

Series CZ0870d

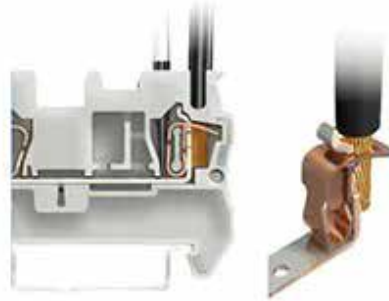

It is easier to be wired by cage type terminal which is certified internationally.



Explosion-proof platform light fittings
C-90°



Bracket type lamps for ceiling mounting



Bracket type lamps with bracket multiple
angle adjustment



Bracket type lamps with chain

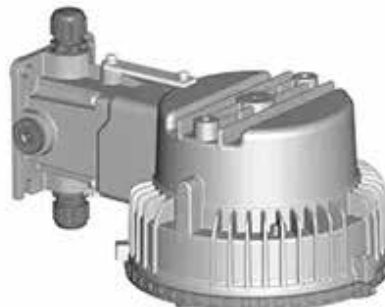

Wall type lamp



Explosion-proof platform light fittings
D-25°



فرست اوتوماشن

Light Fittings

Series CZ0870d

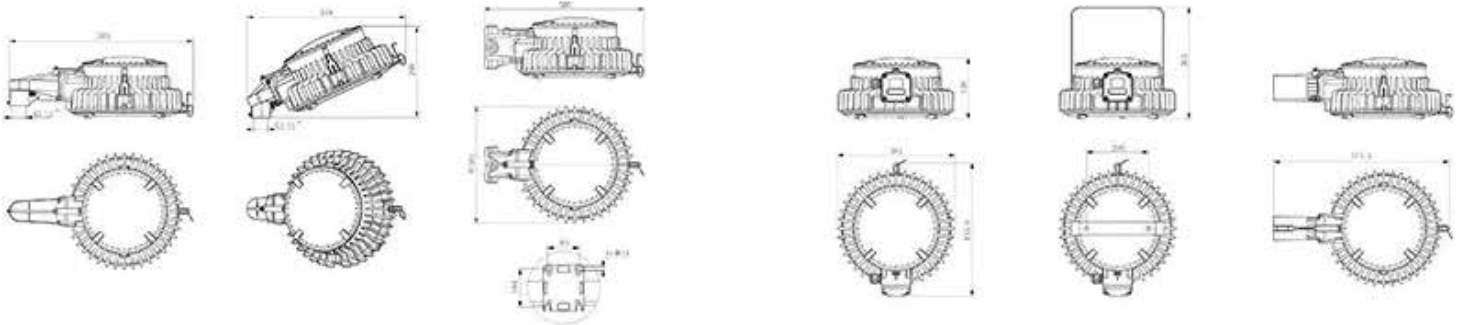

Requires a halon or modified plastic M25 cable gland.



C — Lamp cap mounted in the angle of 90° fence type

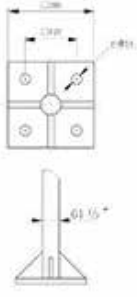

Flange type



D — Lamp cap mounted in the angle of 25° fence type

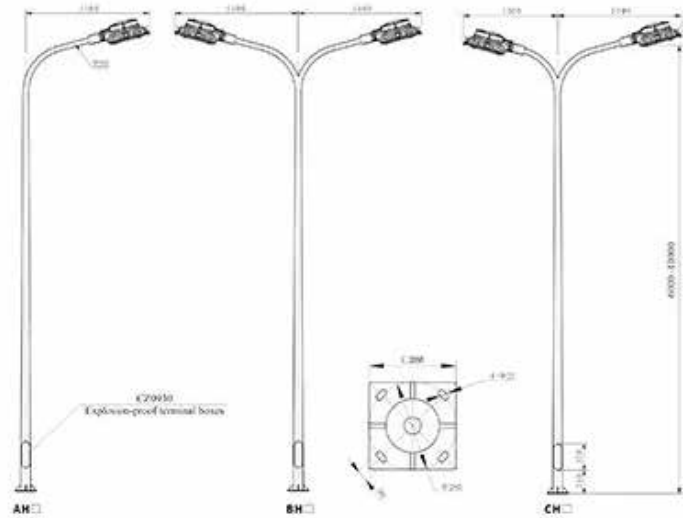

CZ0930 Explosion-proof terminal boxes

AH

BH

CH

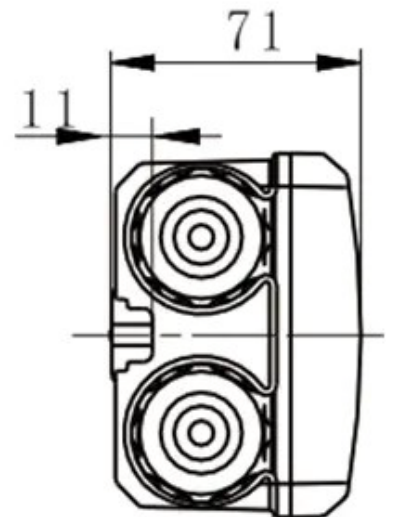
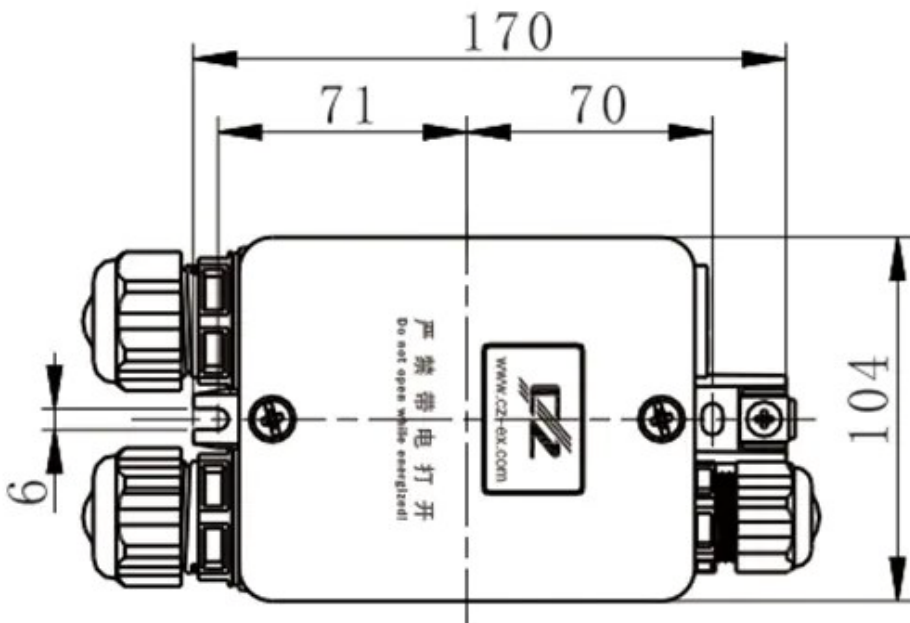



فرست اوتوماشن

Light Fittings

Series CZ0870d



Illustration

Order No.

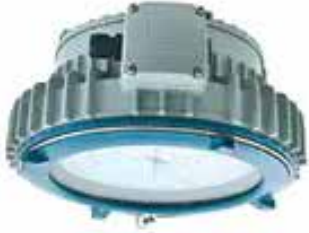

B

CZ0870d/105□-LED90W-□-B+□

CZ0870d/105□-LED120W-□-B+□

CZ0870d/105□-LED160W-□-B+□



C

CZ0870d/108□-LED90W-□-B+□

CZ0870d/108□-LED120W-□-B+□

CZ0870d/108□-LED160W-□-B+□



D

CZ0870d/110□-LED90W-□-B+□

CZ0870d/110□-LED120W-□-B+□

CZ0870d/110□-LED160W-□-B+□



E

CZ0870d/112□-LED90W-□-B+□

CZ0870d/112□-LED120W-□-B+□

CZ0870d/112□-LED160W-□-B+□



F

Contact

info@first-automation.com.eg/ • 01101619222 – 01100200886 • https://first-automation.com.eg/



فرست اوتوماشن

Light Fittings

Series CZ0870d



Optional Ex components



| CZ0220 Series Plastic stopping plugs, the reducer



| CZ0221 Metal cable glands



| CZ0220 Series Plastic cable glands, stopping plugs



| CZ0226 Increased safety cable glands



| CZ0527, CZ1725/27 Increased safety breathing, drainage valve



| CZ0227 Increased safety metal cable glands



| CZ1725/1C Metal cable glands



| CZ1725/2A Metal cable glands



| CZ1725/3A Metal stopping plug



| CZ1725/1A Metal cable glands



| CZ1725/4A The reducer



| CZ1725/1B Metal cable glands



فرست اوتوماشن

Light Fittings

Series CZ0870d



Accessories



D0879/2

Mounting bracket
Accessories for bracket type lamp



D8726

Accessories for platform type lamp, G1 1/2 "
galvanized steel
pipe material and powder coated surface



CZ0930

Code: 10,11
Single lamp equipped
with one fuse

code: 20,21
Double lamps equipped
with two fuses



فرست اوتوماشن

Light Fittings

Series CZ0870d



Accessories



D8725

Lamp pole of fence type
Accessories for platform type lamp, G1 1/2 "
galvanized steel
pipe material and powder coated surface

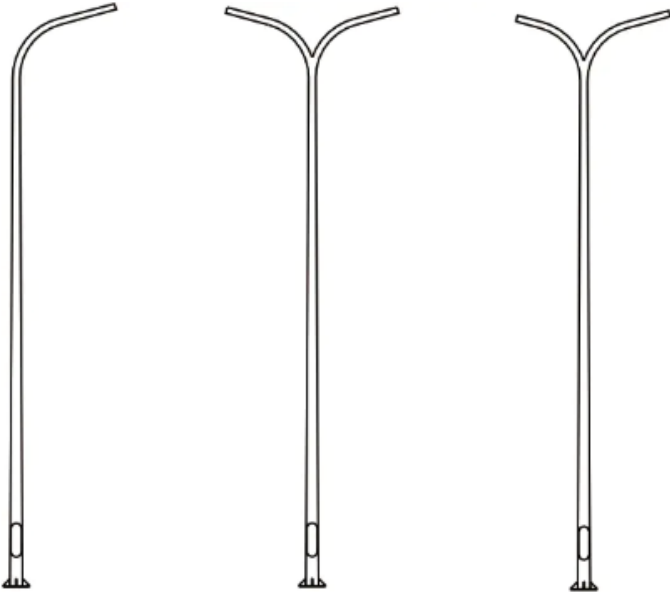

AH,BH,CH

AH:Lamp pole of single arm
BH:Lamp pole of double arms with equal length
CH:Lamp pole of double arms with non-equal
length